

SWIMLINE® HYDROTOOLS™

by International Leisure Products, Inc.

AUTOMATIC CHLORINE FEEDER

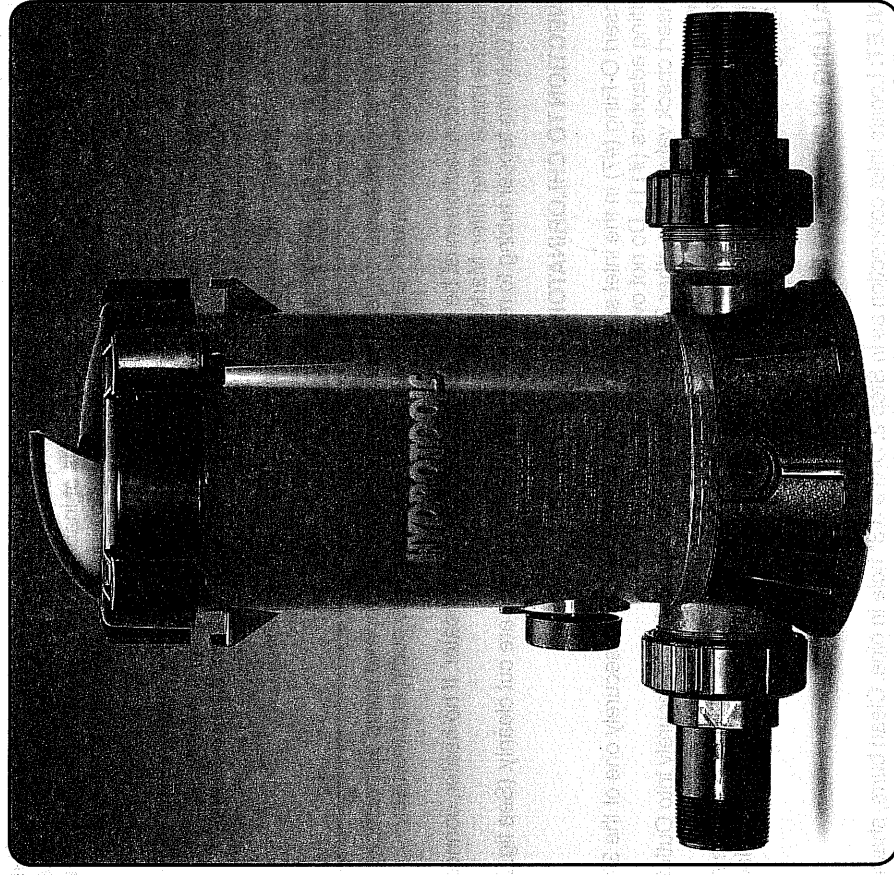

OWNER'S GUIDE INSTALLATION AND OPERATING INSTRUCTIONS

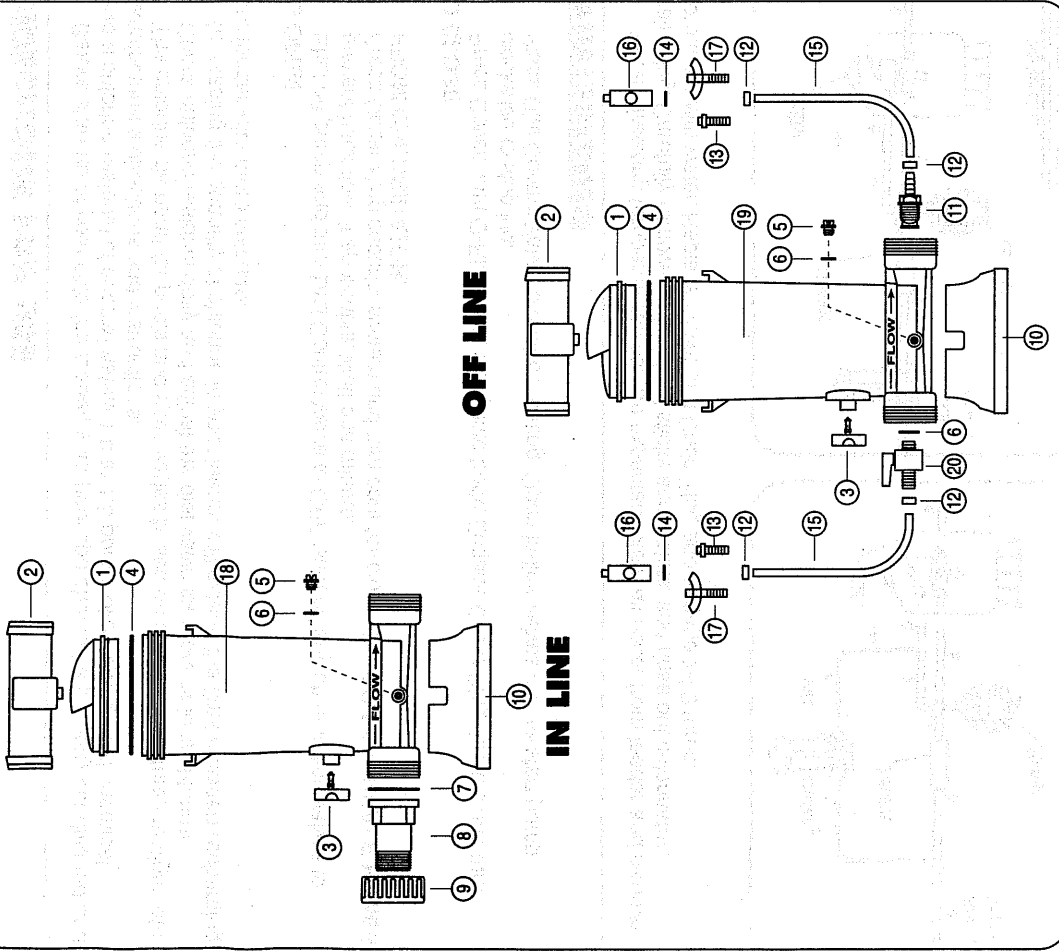

PARTS LIST

No.	Description	In Line	Off Line	No.	Description	In Line	Off Line
1	Cover	X	X	11	3/8" Fitting Adapter		X
2	Cover Ring	X	X	12	Saddle		X
3	Control Valve Assembly	X	X	13	Saddle Fitting		X
4	Cover O-Ring	X	X	14	Saddle Fitting Gasket		X
5	Drain Plug	X	X	15	Plastic Tubing		X
6	Drain Gasket	X	X	16	Saddle Clamp		X
7	O-Ring	X	X	17	Saddle Fitting For Tube D.50		X
8	1-1/2" Pipe Adapter	X		18	Chlorinator Body	X	
9	Lock Nut	X		19	Chlorinator Body		X
10	Chlorinator Base	X	X	20	1/4" Ball Valve		X

WE RESERVE THE RIGHT TO CHANGE ALL OR PART OF THE FEATURES OF THE ARTICLES OR CONTENTS OF THIS DOCUMENT WITHOUT PRIOR NOTICE.

Your chlorine feeder is designed for installation in the return line to your pool or spa, next to your filter system. It uses slow-dissolving Trichloro-S-Triazinetrione (Tri-Chlor) or Bromochloro-5,5 dimethylhydantoin (Bromine) large or small tablets (or sticks) ONLY. No other type of chemical should ever be used in your chlorine feeder. By regulating the dial type control valve between MAX (more chlorine) and OFF (less chlorine) and the amount of Tri-Chlor tablets you place in the feeder, you can easily adjust the chlorine feed rate that is necessary to maintain the proper chlorine residual for your pool.

CAUTION-READ CAREFULLY

Use only slow dissolving Trichloro-S-Triazinetrione (Tri-Chlor) or Bromochloro-5,5 dimethylhydantoin (Bromine) sticks/tablets. **NEVER MIX CHEMICALS**, fire or explosion may result. **Always use rubber gloves & eye protection when handling pool chemicals!** Never remove top cover while chemical feeder is in operation. Shut off pump and valves before opening feeder.

Avoid breathing fumes when opening cover. Be sure pool return line is open except when servicing to prevent build-up of gas in chlorinator.

Always read label and carefully follow chlorine manufacturer's and dealer's recommendations for proper water conditioning and daily chlorine requirements for your particular pool and area. Do not leave chlorine in feeder for long periods of inactivity with no water flowing through the feeder, i.e., vacation. Remove unused chlorine following above safety procedures.

INSTALLATION IN LINE

1. Install the chlorine feeder after the heater. If no heater, install after the filter.
2. Use Teflon Tape on all male threaded fittings and O-Ring lubricant on all O-Rings.
3. Connect 1-1/2" pipe adapter (#8) to filter outlet and 1-1/2" hose fitting to return line. Do not overtighten. Use clamps on all hose fittings. (not furnished)

INSTALLATION OFF LINE

1. Install the chlorine feeder on level surface as close to the filter and pump as practical.
2. The inlet connection must be made in the piping between the pump and the filter. Mark Pipe.
3. The outlet connection must be made in the piping after the heater. If no heater, connection must be made after filter. Mark Pipe.
4. Cut Chlorine feeder tubing to required lengths. Be sure ends are cut cleanly. (See fig. 2)

CONNECTION TO CHLORINATOR

5. Insert O-Ring (#7) in the inlet side (below dial valve) and thread securely one of the 3/8" fitting adapters (#11). Do not overtighten. (See fig. 3)
6. Insert check valve in the other 3/8" fitting adapter (#13) and thread securely into Outlet side of chlorinator. (See fig. 3)
7. To connect tubings to chlorinator, place Compression Nut (#12) over tubing and slide nut up about 1". Insert the tubing all the way into adapter socket and, holding tubing in place, handtighten nut firmly. (See fig. 3)

INSTALLING IN PLUMBING LINES

8. **INLET:** Locate inlet connection as in Step 2. Drill a 3/8" hole in pipe. Clean burrs, shavings, etc. Fit Saddle Fitting with gasket (#13, #14), into shaped hole in clamp and insert fitting into 3/8" hole. Secure clamp around fitting, gasket and pipe and tighten securely. (See fig. 4)
9. **OUTLET:** Locate outlet connection as in Step 3. Drill a 3/8" hole and install Saddle fitting as in Step 8.
10. Connect tubings as in Step 7. Do not overtighten. After starting up system, recheck all connections for leaks.

DIRECTIONS FOR USE

Before start up of your chlorine feeder, your pool/spa should be properly conditioned and have a chlorine residual of approximately 1.0 to 1.5 ppm. Follow dealer and chemical manufacturer's directions and instructions.

The chlorine demand for pools and spas varies based on use, temperature, sunlight, etc.. Check chlorine residual daily and adjust the dial valve for more or less chlorine.

Increasing the quantity of chlorine in your feeder will extend the time between recharging your feeder with more chlorine.

TO OPEN

1. Shut off pump and turn Dial Control Valve to OFF. Shut off any other in-line valves to prevent back flow, if applicable. Wait one minute.
2. Press Cover Ring security system and turn counter-clockwise. **DO NOT INHALE FUMES FROM CHLORINATOR.**

TO CLOSE

1. Press Cover, with O-Ring seal, firmly into body. Engage Cover Ring threads and turn clockwise to stop lug.
2. Place Dial Control Valve to desired setting. Open in-line valves and re-start pump.

WINTERIZING

Where freezing temperatures can be expected, drain all water from feeder and remove Drain Plug. Carefully remove undissolved sticks and tablets, and rinse out chlorinator thoroughly with water. Replace Cover and Drain Plug and engage 1-1/2 turns.

